

# Product Data Sheet

1/4 2011-10-27 AHT TS PM

AHT Cooling Systems GmbH  
 NL – Deutschland  
 Sonntagshornstraße 19  
 83278 Traunstein  
 Germany

Tel.: +49(0)861 / 209 32 – 0  
 Fax: +49(0)861 / 209 29 – 90



\*picture may contain options

## AHT AC W

Version: **R290a EU**  
 Aircurtain Cooler  
 Open Front

### Dimensions:

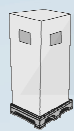

#### Packing

W [mm] 965  
 D [mm] 765  
 H [mm] 1620



#### Outside

W [mm] 914  
 D [mm] 766  
 H [mm] 1495

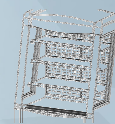

#### Inside

W [mm] 820  
 D [mm] 400  
 H [mm] 836

### Loadability:

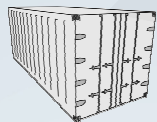

**20'**  
18

**40'**  
36

**40'HC**  
36

**Truck**  
-

### Weights:

Gross weight [kg] 142,6  
 Net weight [kg] 124,8

### Volume:

Gross volume [L] 325  
 Net volume [L] 250

### Conditions:

**Max. temperature:** 24°C  
**Max. humidity:** 55%rH

**Min. inside:** 0°C  
**Max. inside:** 7°C

**Outdoor use:** No

**Climate Class:** 8 M2

**Voltage:** 230V/50Hz

**Product Data Sheet AHT W**  
2/4 2011-10-27 AHT TS PM

**Technical:**

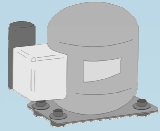

**Compressor**  
Embraco NT6217U



**Temperature Control**  
Dixell XR 60 CX / 5N0C5

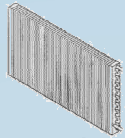

**Evaporator**  
Finned Evaporator  
Convection defrost

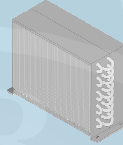

**Condensor**  
Low Maintenance



**Evap. Fan**  
Radial Fan



**Cond. Fan**  
Air forced

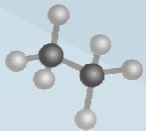

**Refrigerant**  
R290



**Refrigerant quantity**  
0,150 kg



**Voltage:** 230V/50Hz  
**Power consumption:** 850 W  
**Energy Consumption kWh/d:** 13,2 kWh/d  
**Ampere** 5,0 A



**Insulation material:** Polyurethane  
**Foaming agent:** CO2  
**Insulation thickness:** 50 mm



**Outer casing:** Painted Steel / Plastic  
**Outside back:** Painted Steel  
**Innerliner:** Painted Steel  
**Door:** Aircurtain



**Total noise [dB(A)]:** 52,5 db(A)



**Adjustable feet:** -

**Wheels:** 4 barrel wheels

**Product Data Sheet AHT W**

3/4 2011-10-27 AHT TS PM

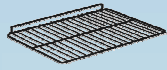

**Number of shelves:** 3 pcs **Min. shelf distance [mm]:** 150

Size 1 (metal sheet 1) 1x	Size 2 (metal sheet 2) 2x	Size 3 (bottom layer)
W [mm] 820	W [mm] 820	W [mm] 820
D [mm] 320	D [mm] 390	D [mm] 422



**Lighting vertical:** 2x2 LED 14W (á 3,5W)  
**Lamp 1:**  
**Lighting horizontal:** 1x LED (3,5W)  
**Lamp 2:**



**Options:** Shelf strip holder  
 Branding  
 Customized color  
 IQ Fan  
 Adjustable feet



**Packout 1:** 360 x 0,33 L Can  
**Packout 2:**  
**Packout 3:**  
**Packout 4:**



**Certificates:** VDE / ETL

S&C ÖN/|ã  
 Q @ O @ a cã / O \\*  
 O E AU-ã:ãã ^:A F  
 FGGEJ O \ / |ã  
 Q } KEI J A E D H E A I A F E A € A G  
 Qã KEI J A E D H E A I A F E A € A F  
 ^ T aãã } O \ æ c E a \ / |ã E ^  
 Q c \ } ^ c O j K D , , E æ c E a \ / |ã E {