

R 190



Storage Bin 243 kg

Complete range: R 100 - R 130 - R 150 - R 190 - R 250 - R 300 - R 400

Technical features

- Convenient & hygienic internal ice scoop holder.
- Exterior panels in durable stainless steel.
- Polyurethane Insulation.
- High density, non-corroding Polyethylene bin liner, is designed with easy-to-clean rounded corners, and resists scratches and scuffs from ice scoops.
- Robust door frame will resist operational abuse.
- Rounded door-lip profile allows an easy reach for enhanced ease of operation.
- Fully removable door gasket seals door opening to reduce ice melt, easily disassembled for manual cleaning.
- Internal ice deflector enhances ice distribution to maximize bin storage capacity.
- Load resistant, stainless steel adjustable legs.
- Bin Caster available on request for selected models.
- Storage bin base drain tube conveniently rotates at 360° radius to allow ease-of-connection with any floor water drain position.



Bin	Compatibility	Ice Machine
R 190	CBT30EMCD	SVD 152-222
	✓	SVD 203-303-503
	CBT30EFSD	SPN 125-255-405-605
	CBT30EFSD	SNM 300-500

LEGEND:

- ✓ : Perfect combination between ice maker and bin
- : Ice chute cut-out performed upon installation
- CBTxxxxxxxx : need additional bin top

Bin capacity

243 kg of ice

Dimensions and weight

Net size WxDxH	768 x 866 x 1274 mm
Net weight	55 kg
Shipping size WxDxH	830 x 950 x 1310 mm
Shipping weight	70 kg

Technology and Certifications



Specifications and design are subject to change without notice

R 190

SIMAG

Storage Bin 243 kg

Complete range: R 100 - R 130 - R 150 - R 190 - R 250 - R 300 - R 400

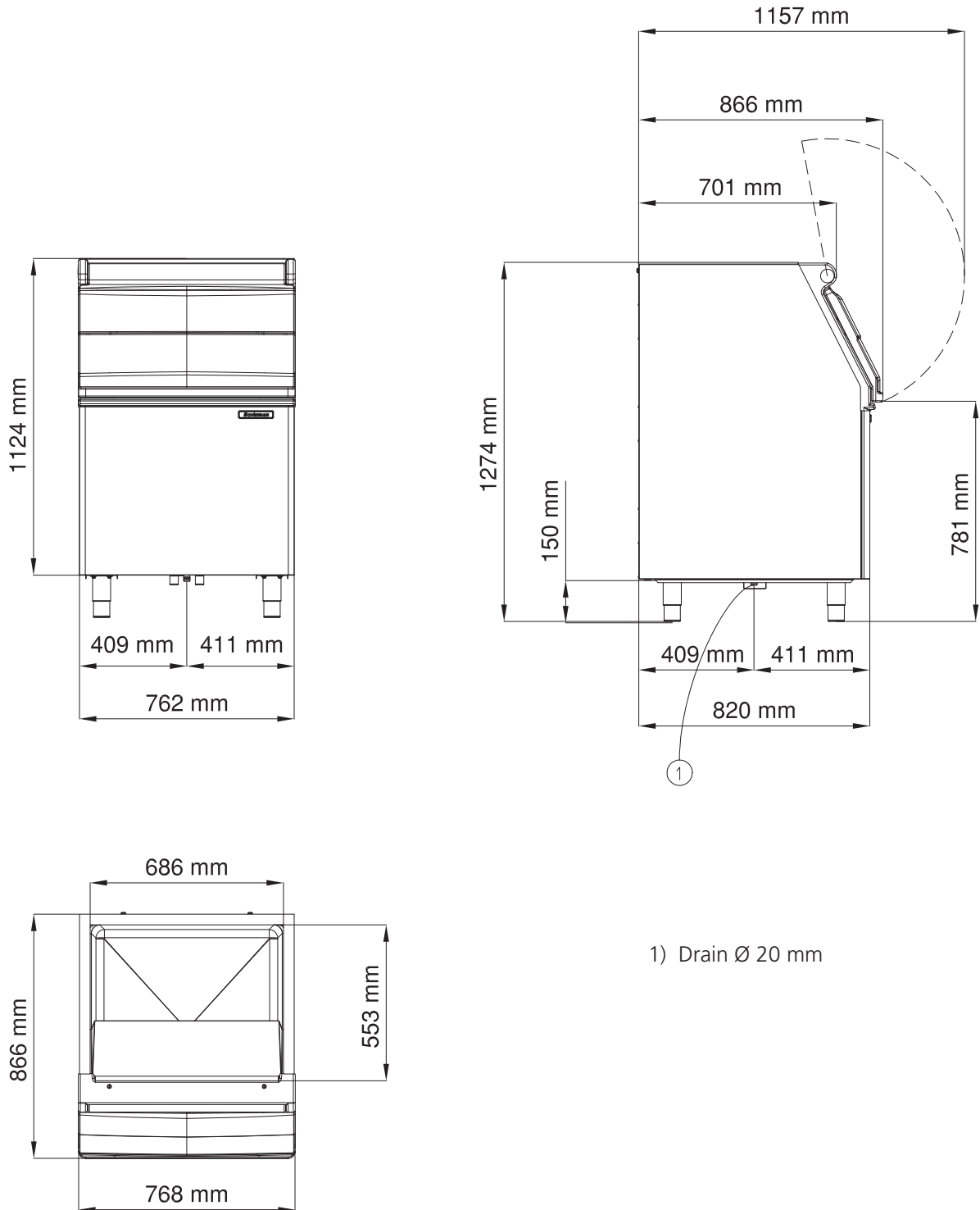

MILANO OFFICE
Sales Dept.
Tel. +39 02 93900215
e-mail: sales@simag.it
Service Dept.
Tel. +39 02 93960357
e-mail: service@simag.it

SIMAG FAR EAST
Singapore Office
Tel. ++65 6738 5393
e-mail: scotsman@scotsman.com.sg

www.simag.it