

SVD 222



210 kg Modular Ice Machine

Complete range: SVD 152 - SVD 203 - SVD 222 - SVD 303 - SVD 503

Technical features

- High efficiency vertical evaporator cuber
- Stainless Steel finishing
- Low power and water consumption
- Self diagnostic system with led indicators
- Easy removable condenser filter
- Front evaporator access: immediate access to the evaporating plate for quick self-maintenance operations
- Head only ice maker: requires a separate storage bin to collect the ice produced



Matching bins

Machine	Bins		kg
SVD 222	✓	R100	129
	✓	R130	168
		CBT30EMCD R150	181
		CBT30EMCD R190	243
	●	RC300	391

- ✓ : Direct coupling
- : Ice chute cut-out performed upon installation
- CBTxxxxxxx: accessory needed

Voltage

230/50/1 Standard version
220/60/1 Available on demand

Technology and Certifications



Type of ice

Half dice cube

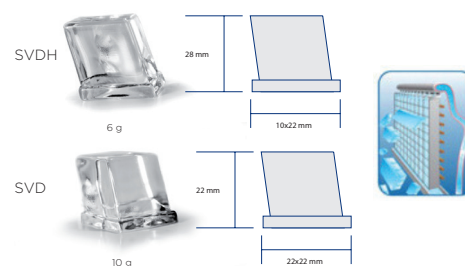

Machine dimensions

Net size WxDxH	558 x 610 x 609 mm
Net weight	65 kg
Shipping size WxDxH	620 x 680 x 800 mm
Shipping weight	80 kg

MILANO OFFICE
Sales Dept.
Tel. +39 02 93900215
e-mail: sales@simag.it
Service Dept.
Tel. +39 02 93960357
e-mail: service@simag.it

SIMAG FAR EAST
Singapore Office
Tel. ++65 6738 5393
e-mail: scotsman@scotsman.com.sg

www.simag.it

SVD 222

SIMAG

210 kg Modular Ice Machine

Complete range: SVD 152 - SVD 203 - SVD 222 - SVD 303 - SVD 503

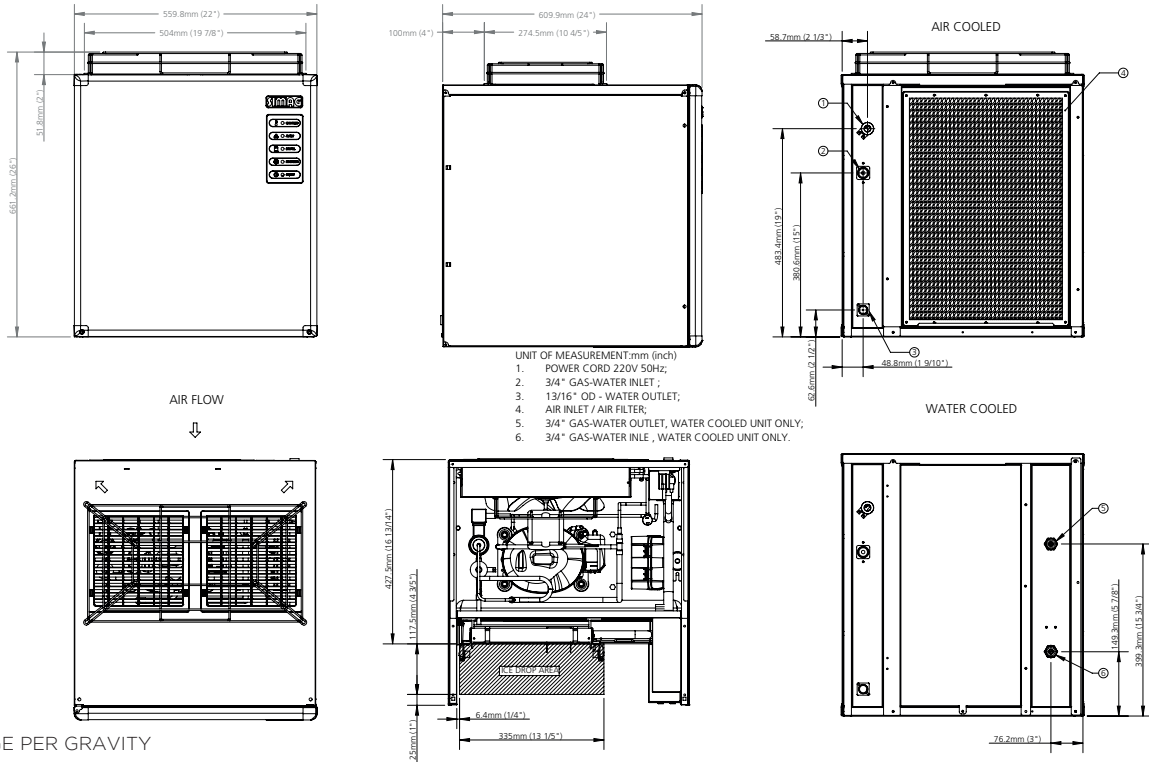

Operating Limits

	Minimum	Maximum
Air temperature	10°C	40°C
Water temperature	5°C	35°C
Water pressure	1 bar	5 bar
Electrical voltage	-10 %	+10 %

Specifications and design are subject to change without notice

Model	Voltage	Daily production kg		Power input Watt (*)	Refrigerant		Fuse A	Consumptions (**)		
		10°C/10°C	21°C/10°C		Type	Charge kg		kWh/100kg	kWh/24h	Water l/h
SVDH 222 A	230/50/1	210	180	900	R452A	0.800	16	14.8	20.7	9.1
SVDH 222 A	230/50/1	215	200	1250	R404A	0.730	16	16.3	24.5	10.3
SVD 222 A	230/50/1	210	180	1000	R452A	0.800	16	14.8	20.7	9.1
SVD 222 A	230/50/1	215	200	1250	R404A	0.730	16	16.3	24.5	10.3
SVDH 222 W	230/50/1	210	180	900	R452A	0.500	16	8.6	14.6	137.0
SVDH 222 W	230/50/1	220	210	1250	R404A	0.500	16	9.7	17.5	152.0
SVD 222 W	230/50/1	210	180	1200	R452A	0.500	16	9.7	15.7	137.0
SVD 222 W	230/50/1	220	210	1250	R404A	0.500	16	9.7	17.5	152.0

(*) Power Input: at 43°C Ambient Temperature

(**) Water Consumption: at 32°C Air and 21°C Water